



PRESSURE SEAL STEELGRAPH G11N

Composition

The gasket is composed of high-quality expanded mineral graphite, reinforced with Nickel inserts. These materials are selected to provide an optimal combination of elasticity and strength, ensuring long-lasting and reliable performance.

Characteristics

Steelgraph G11N exhibits high elasticity thanks to the expanded graphite, allowing perfect adaptability to sealing surfaces. The Nickel inserts give the gasket superior resistance to extrusion, ensuring effective sealing even under high pressures and in the presence of corrosive fluids.

Applications

This gasket is ideal for Pressure Seal Valves and the gates of high and medium-pressure condensers found in thermal power plants. Thanks to its ability to withstand extreme conditions and ensure reliable sealing, it is widely used in industrial environments where safety and reliability are paramount.

Tech Data

	P bar	lbf/in ²	Vm/S	f/pm	pH	T °C	T °F
	1500	22500			0÷14	-100 ÷ 450 / 650	-150 ÷ 840 / 1200

- Never use the product at its maximum rated temperature and pressure. Consult the manufacturer for further information.
- The peak temperature can be sustained only for short exposure periods.
- With weakly oxidizing agents and hot air, the temperature must be limited to 450 °C.
- With steam and non-oxidizing fluids, the temperature must be limited to 650 °C.

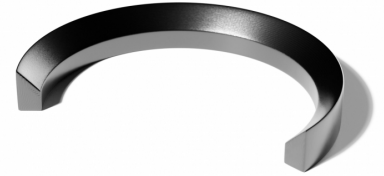

Pressure Seal Steelgraph G11N

Steelgraph G11N is an innovative gasket obtained through the molding process of expanded graphite with the insertion of Nickel. This unique combination offers excellent adaptability and resistance, ensuring reliable sealing even in extreme conditions.



The information provided in this publication, as well as that supplied to users in other forms, is based on our experience and communicated according to the best knowledge available. However, since numerous factors beyond our knowledge and control may influence the use of the products, no warranty, explicit or implicit, is given regarding such content. The operating limits indicated do not constitute confirmation that these values can be applied simultaneously. Avoid using the product at the maximum temperature and pressure limits. The maximum temperature is sustainable only for short periods under specific conditions. Specifications may be changed without notice. The images in the DS may not accurately represent the product's color and/or marking.



Carrara S.p.A.,
Via Provinciale 1/E - 25030 Adro - BS - Italia
tel. +39 030 7451121 www.carrara.it - info@carrara.it