



# PRESSURE SEAL STEELGRAPH G11

## Composition

The gasket is composed of high-quality expanded mineral graphite, reinforced with SS316L steel inserts. These materials are selected to provide an optimal combination of elasticity and strength, ensuring long-lasting and reliable performance.

## Characteristics

Steelgraph G11 exhibits high elasticity thanks to the expanded graphite, allowing perfect adaptability to sealing surfaces. The SS316L steel inserts give the gasket superior resistance to extrusion, ensuring effective sealing even under high pressures and in the presence of steam.

## Applications

This gasket is ideal for Pressure Seal Valves and the gates of high and medium-pressure condensers found in thermal power plants. Thanks to its ability to withstand extreme conditions and ensure reliable sealing, it is widely used in industrial environments where safety and reliability are paramount.

## Tech Data

	P bar	lbf/in <sup>2</sup>	Vm/S	f/pm	pH	T °C	T °F
	1500	22500			0 ÷ 14	-200 ÷ 450 / 650	-330 ÷ 840 / 1200

- Never use the product to the maximum temperature and pressure associated. Consult the manufacturer for further information
- The peak temperature can be sustained for short exposures
- With weakly oxidizing agents and hot air the temperature must be limited to 450 °C
- With steam and non-oxidizing fluids the temperature must be limited to 650 °C

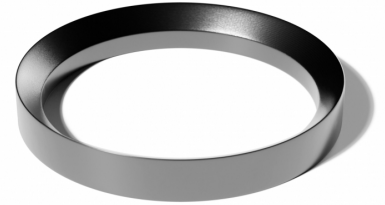

## Pressure Seal Steelgraph G11

Steelgraph G11 is an innovative gasket obtained through the molding process of expanded graphite with the insertion of SS316L steel laminates. This unique combination offers excellent adaptability and resistance, ensuring reliable sealing even in extreme conditions.



The information in this publication, as well as any additional information provided to users, is based on experience and is shared to the best of our current knowledge. However, due to numerous factors beyond our knowledge and control that may affect the use of these products, no warranties are provided or implied regarding this information. The operating limits presented in this publication do not imply that these values can be applied simultaneously. Do not use the product at the maximum temperature and pressure values simultaneously. The maximum temperature is suitable only for short-term exposure under specific conditions. Specifications are subject to change without prior notice. The picture in the DS may not accurately depict the exact color and/or markings of the product.



**Carrara S.p.A.**,  
Via Provinciale 1/E - 25030 Adro - BS - Italia  
tel. +39 030 7451121 / fax +39 030 7451130  
[www.carrara.it](http://www.carrara.it) - [info@carrara.it](mailto:info@carrara.it)