



PLANISTEEL CAMPROFILE MICA

Composition

- NR, IR and LR configuration
- Metal according to requirements
- MICA filler



Type NR

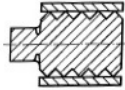

Type IR

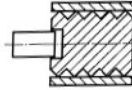

Type LR

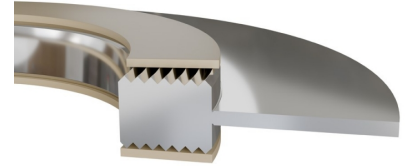

Characteristics

Planisteel Camprofile MICA gaskets are composed of a metallic core serrated on both sides, subsequently covered with a mica tape that provides the sealing function. The concentric grooves of the core ensure excellent tightness even with reduced bolt loads, while the facing guarantees adaptation to surface irregularities of the flanges.

Unless otherwise specified by the customer, the profile design is manufactured in accordance with ASME B16.20. Planisteel Camprofile gaskets can also be manufactured in compliance with EN 1514-6 and EN 12560-6, or with other customized profiles.

According to the EN 1514-6 classification, Planisteel Camprofile gaskets can be manufactured without a ring (NR), with an integral ring (IR), or with a loose/non-integral ring (LR). The material of the loose location ring may be carbon steel.

The typical construction details of Planisteel Camprofile gaskets are as follows.

Performance Specifications	UM	EN1514-6 EN12560-6	ASME B16.20
Core thickness	mm	4,00	3,00
Groove depth	mm	0,40	0,30
Location ring thickness	mm	0,50	1,60
Facing material thickness	mm	0,50	0,50
Tip width	mm	0,10	0,10
Min. Gasket Seating Stress - $S_{gmin}-S_{L=0.001}$	MPa	42	42
Min. Gasket Operating Stress - $S_{gmin}-O$	MPa	30	30
Max Gasket Operating Stress - S_{gmax}	MPa	280	280

- The sealing factors refer to the IR and LR design of the stainless steel gasket.
- The maximum service temperature of the spiralwound gasket depends on the metal tape.
- The thermal capacity of the mica filler is 1000°C.

Applications

Gaskets for line flanges and heat exchangers suitable for pressure classes 150 to 2500. They are designed for sealing flanges in all applications in chemical plants, petrochemical plants, refineries, and power generation facilities.



The information provided in this publication, as well as that supplied to users in other forms, is based on our experience and communicated according to the best knowledge available. However, since numerous factors beyond our knowledge and control may influence the use of the products, no warranty, explicit or implicit, is given regarding such content. The operating limits indicated do not constitute confirmation that these values can be applied simultaneously. Avoid using the product at the maximum temperature and pressure limits. The maximum temperature is sustainable only for short periods under specific conditions. Specifications may be changed without notice. The images in the DS may not accurately represent the product's color and/or marking.

Planisteel Camprofile MICA

Maximum reliability, even under the most extreme conditions.

The Planisteel Camprofile gasket combines robustness with flexibility of use, ensuring flawless sealing even on imperfect flanges and in the presence of high pressures or temperatures. It is the ideal choice for those seeking high performance together with safety and long-lasting flange sealing in industrial plants.



Carrara S.p.A.,
Via Provinciale 1/E - 25030 Adro - BS - Italia
tel. +39 030 7451121 www.carrara.it - info@carrara.it